

Annex 2: Plan Identifying the Land

Notes

1. This drawing has been prepared in accordance with the scope of RPS's appointment with its client and is subject to the terms and conditions of that appointment. RPS accepts no liability for any use of this document other than by its client and only for the purposes for which it was prepared and provided.
2. If received electronically, it is the recipient's responsibility to print to correct scale. Only written dimensions should be used.
3. This drawing should be read in conjunction with all other relevant drawings and specifications.

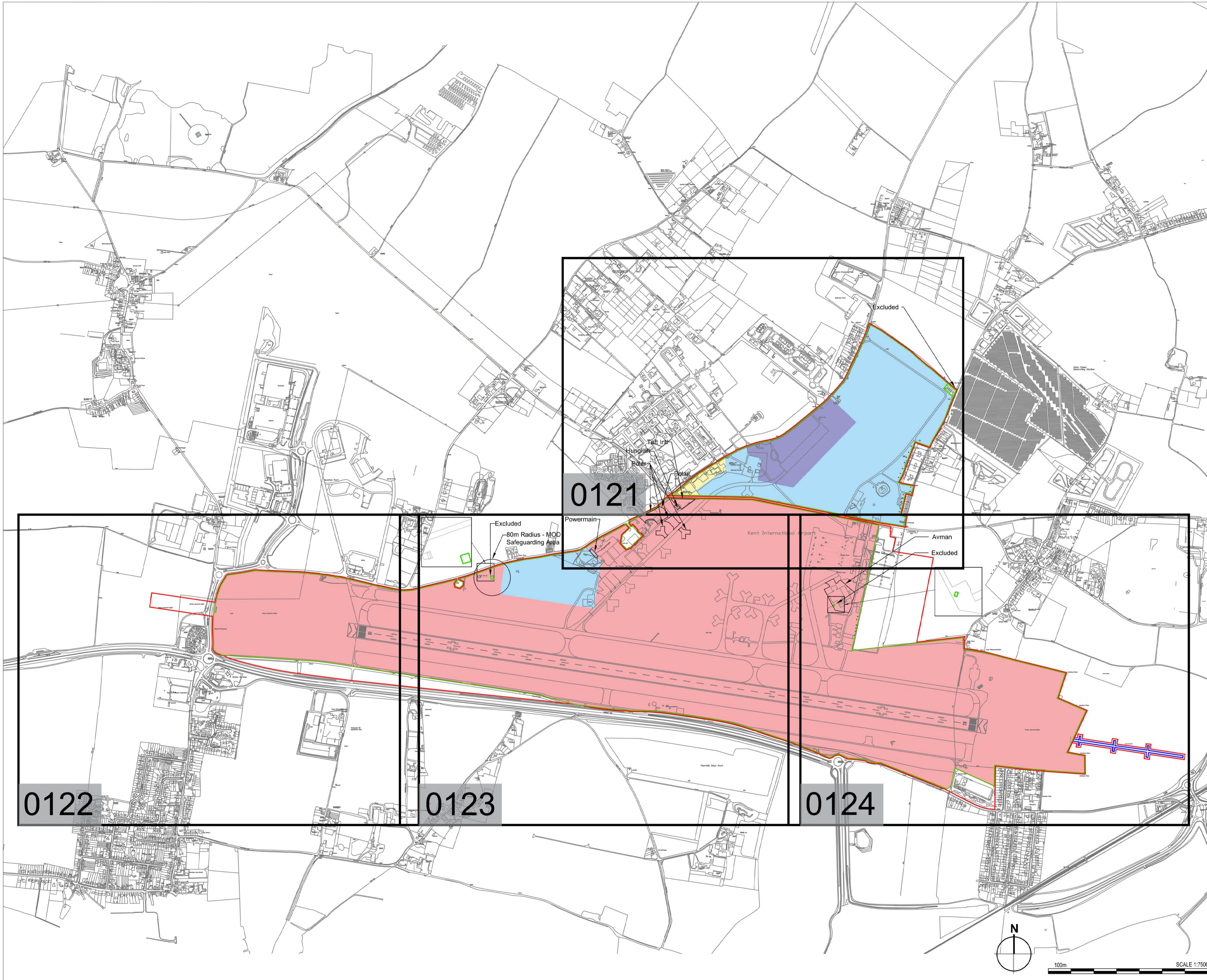

KEY

- Proposed Development
- Land to which access is sought
- Land owned by RiverOak
- Leasehold Land (Excluded)
- K803975 (Plot 1)
- K837264 (Plot 2)
- K806190 (Plot 3)
- K891199 (Plot 4)
- Powermain, Polar, Taft Intl Plots and Avman

P04	Hatches amended. Note to Avman changed.	JH	CJ	21.11.16
P03	Safeguarding area and Avman property added. Hatches and red line boundary adjusted. Key updated.	JH	CJ	18.11.16
P02	First Issue.	DDP	CJ	11.11.16
Rev	Description	By	Ckd	Date



Sherwood House, Sherwood Avenue,
Newark, Nottinghamshire, NG24 1QQ
T: 01636 605 700 E: rpsnewark@rpsgroup.com



Client **RiverOak**
INVESTMENT CORP., LLC

Project Manston Airport Masterplan

Title **Section 53 Key Plan - Sheet 1 of 5**

Status Preliminary Scale 1:7500 @A1 Date Created 11.11.16
 Project Leader GDD Drawn By DDP Checked by CJ

Document Number	Revision	Subsidiary
NK018417-RPS-MSE-X-DR-C-0125	P04	S0

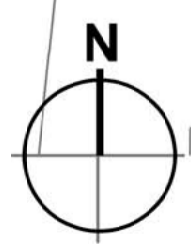

100m SCALE 1:7500

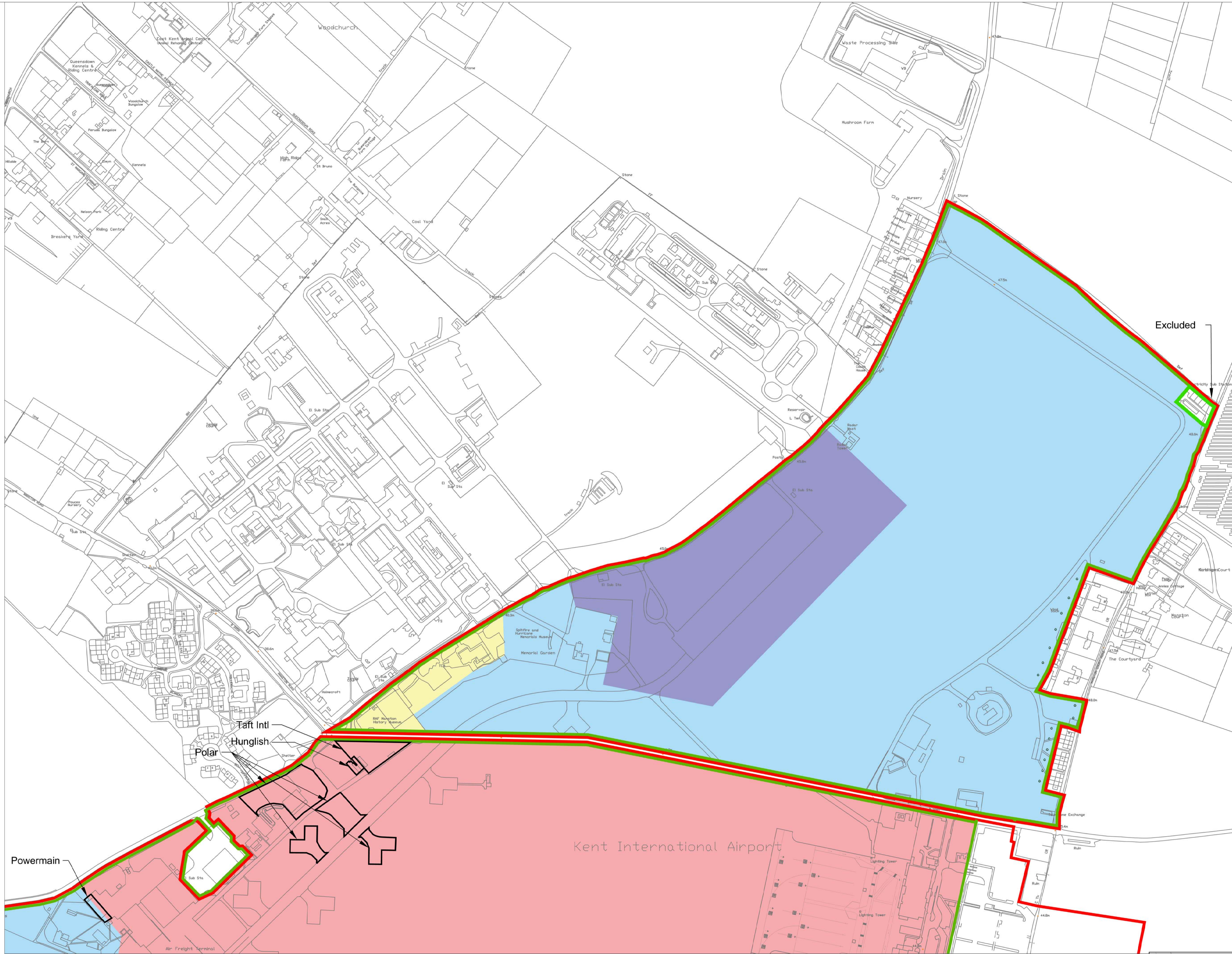

© 2016 RPS Group

Notes

1. This drawing has been prepared in accordance with the scope of RPS's appointment with its client and is subject to the terms and conditions of that appointment. RPS accepts no liability for any use of this document other than by its client and only for the purposes for which it was prepared and provided.
2. If received electronically it is the recipient's responsibility to print to correct scale. Only written dimensions should be used.
3. This drawing should be read in conjunction with all other relevant drawings and specifications.

Key Plan
Scale @ 1:50000



KEY

- Proposed Development
- Land to which access is sought
- Land owned by RiverOak
- Leasehold Land (Excluded)
- K803975 (Plot 1)
- K837264 (Plot 2)
- K806190 (Plot 3)
- K891199 (Plot 4)
- Powermain, Polar, Taft Intl Plots and Avman

P03	Hatches updated. Note moved.	JH	CJ	21.11.16
P02	Hatches and red line boundary adjusted. Key updated.	JH	CJ	18.11.16
P01	First Issue.	DDP	CJ	11.11.16
Rev	Description	By	Ckd	Date

RPS

Sherwood House, Sherwood Avenue,
Newark, Nottinghamshire, NG24 1QQ
T: 01636 605 700 E: rpsnewark@rpsgroup.com

Client **RIVER OAK INVESTMENT CORP., LLC**

Project Manston Airport Masterplan

Title Section 53 Access Plan - Sheet 2 of 5

Status	Scale	Date Created
Preliminary	1:2500 @A1	11.11.16
Project Leader	Drawn By	Checked by
GDD	DDP	CJ

Document Number	Revision	Suitability
NK018417-RPS-MSE-X-DR-C-0121	P03	S0
Project Number	Original / Issue / Layout / Type / Risk / Drawing Number	

x 9 Sheets at 1:2500 scale needed to fit into an A1 Sheet Layout
rpsgroup.com/uk

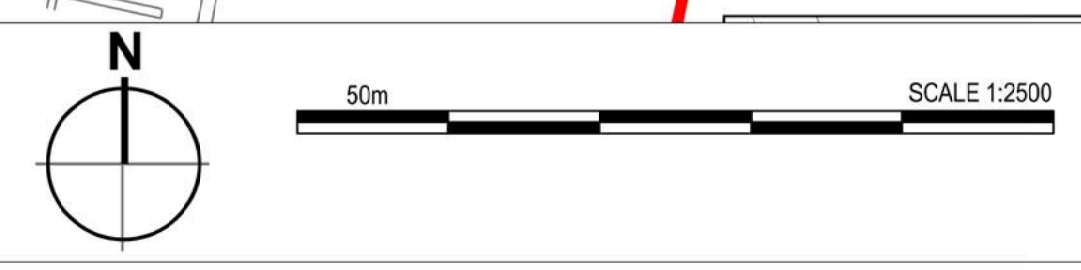

Notes

1. This drawing has been prepared in accordance with the scope of RPS's appointment with its client and is subject to the terms and conditions of that appointment. RPS accepts no liability for any use of this document other than by its client and only for the purposes for which it was prepared and provided.
2. If received electronically it is the recipient's responsibility to print to correct scale. Only written dimensions should be used.
3. This drawing should be read in conjunction with all other relevant drawings and specifications.

Key Plan
Scale @ 1:50000

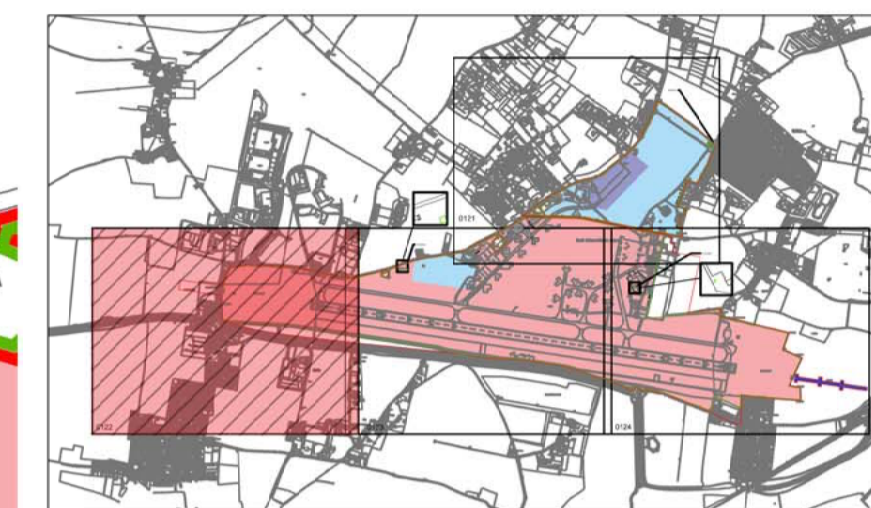

KEY

- Proposed Development
- Land to which access is sought
- Land owned by RiverOak
- Leasehold Land (Excluded)
- K803975 (Plot 1)
- K837264 (Plot 2)
- K806190 (Plot 3)
- K891199 (Plot 4)
- Powermain, Polar, Taft Intl Plots and Avman

P02	Red line boundary adjusted. Key updated	JH	CJ	18.11.16
P01	First Issue.	DDP	CJ	11.11.16
Rev	Description	By	Ckd	Date



Sherwood House, Sherwood Avenue,
Newark, Nottinghamshire, NG24 1QQ
T: 01636 605 700 E: rpsnewark@rpsgroup.com

Client **RIVER OAK**
INVESTMENT CORP., LLC

Project Manston Airport Masterplan

Title Section 53 Access Plan -
Sheet 3 of 5

Status	Scale	Date Created
Preliminary	1:2500 @A1	11.11.16
Project Leader	Drawn By	Checked by
GDD	DDP	CJ

Document Number	Revision	Suitability
NK018417-RPS-MSE-X-DR-C-0122	P02	S0
Project Number	Signature / Date / Issue / Type / Risk / Drawing Number	

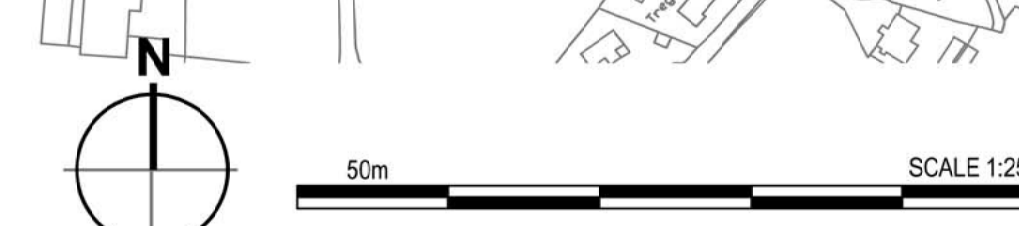
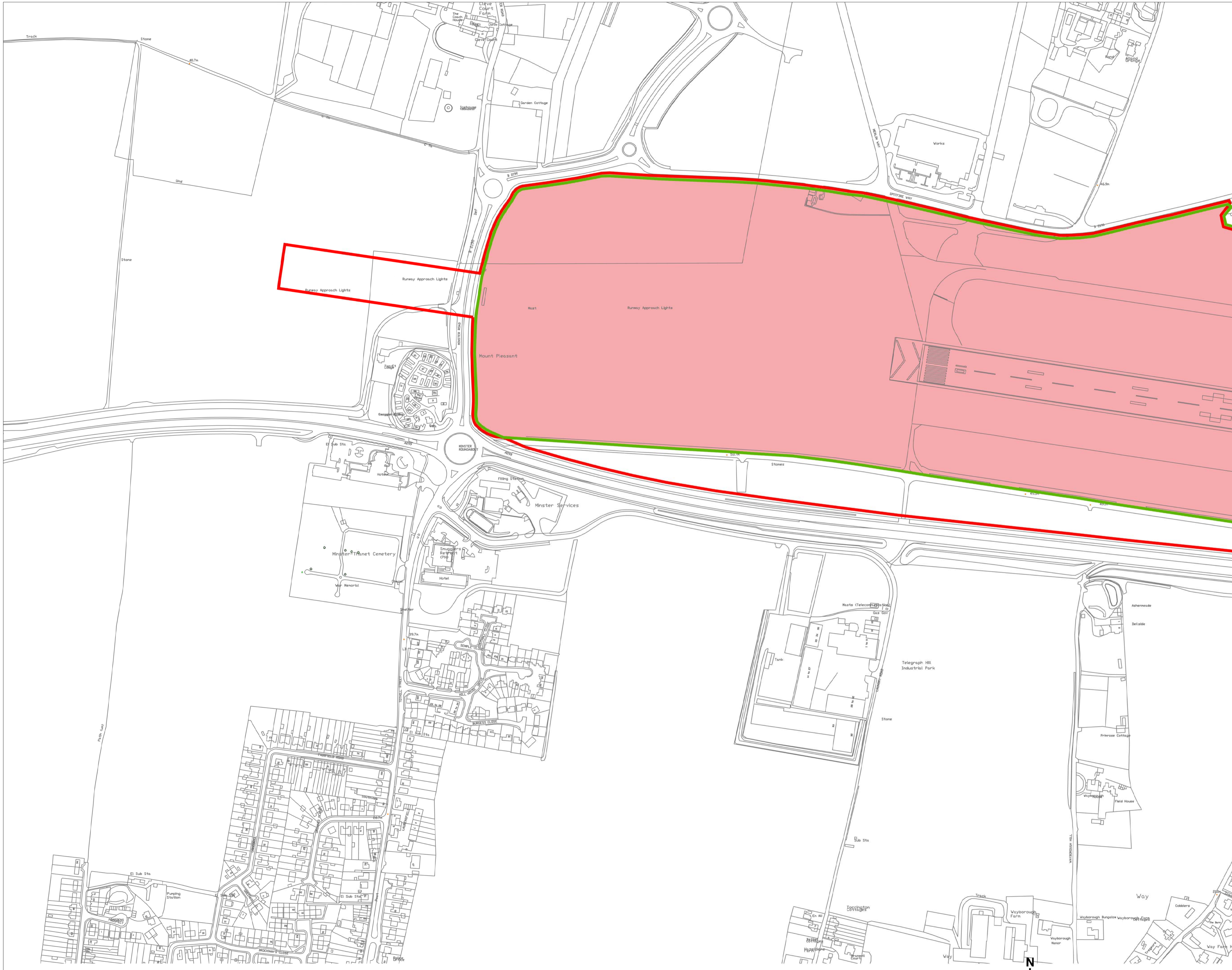



© 2016 RPS Group

Notes

1. This drawing has been prepared in accordance with the scope of RPS's appointment with its client and is subject to the terms and conditions of that appointment. RPS accepts no liability for any use of this document other than by its client and only for the purposes for which it was prepared and provided.
2. If received electronically it is the recipient's responsibility to print to correct scale. Only written dimensions should be used.
3. This drawing should be read in conjunction with all other relevant drawings and specifications.

Key Plan
Scale @ 1:50000

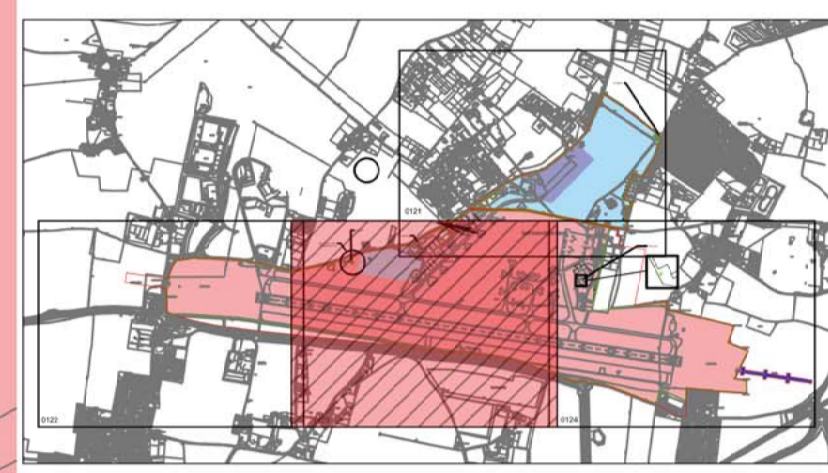

KEY

- Proposed Development
- Land to which access is sought
- Land owned by RiverOak
- Leasehold Land (Excluded)
- K803975 (Plot 1)
- K837264 (Plot 2)
- K806190 (Plot 3)
- K891199 (Plot 4)
- Powermain, Polar, Taft Intl Plots and Avman

P03	Hatches amended.	JH	CJ	21.11.16
P02	Hatches and red line boundary adjusted. Key updated.	JH	CJ	18.11.16
P01	First Issue.	DDP	CJ	11.11.16
Rev	Description	By	Ckd	Date

RPS

Sherwood House, Sherwood Avenue,
Newark, Nottinghamshire, NG24 1QQ
T: 01636 605 700 E: rpsnewark@rpsgroup.com

Client **RIVER OAK INVESTMENT CORP., LLC**

Project Manston Airport Masterplan

Title Section 53 Access Plan - Sheet 4 of 5

Status	Scale	Date Created
Preliminary	1:2500 @A1	11.1.16
Project Leader	Drawn By	Checked by
GDD	DDP	CJ

Document Number	Revision	Suitability
NK018417-RPS-MSE-X-DR-C-0123	P03	S0
Project Number	Signature / Date / Issue / Type / Risk / Drawing Number	

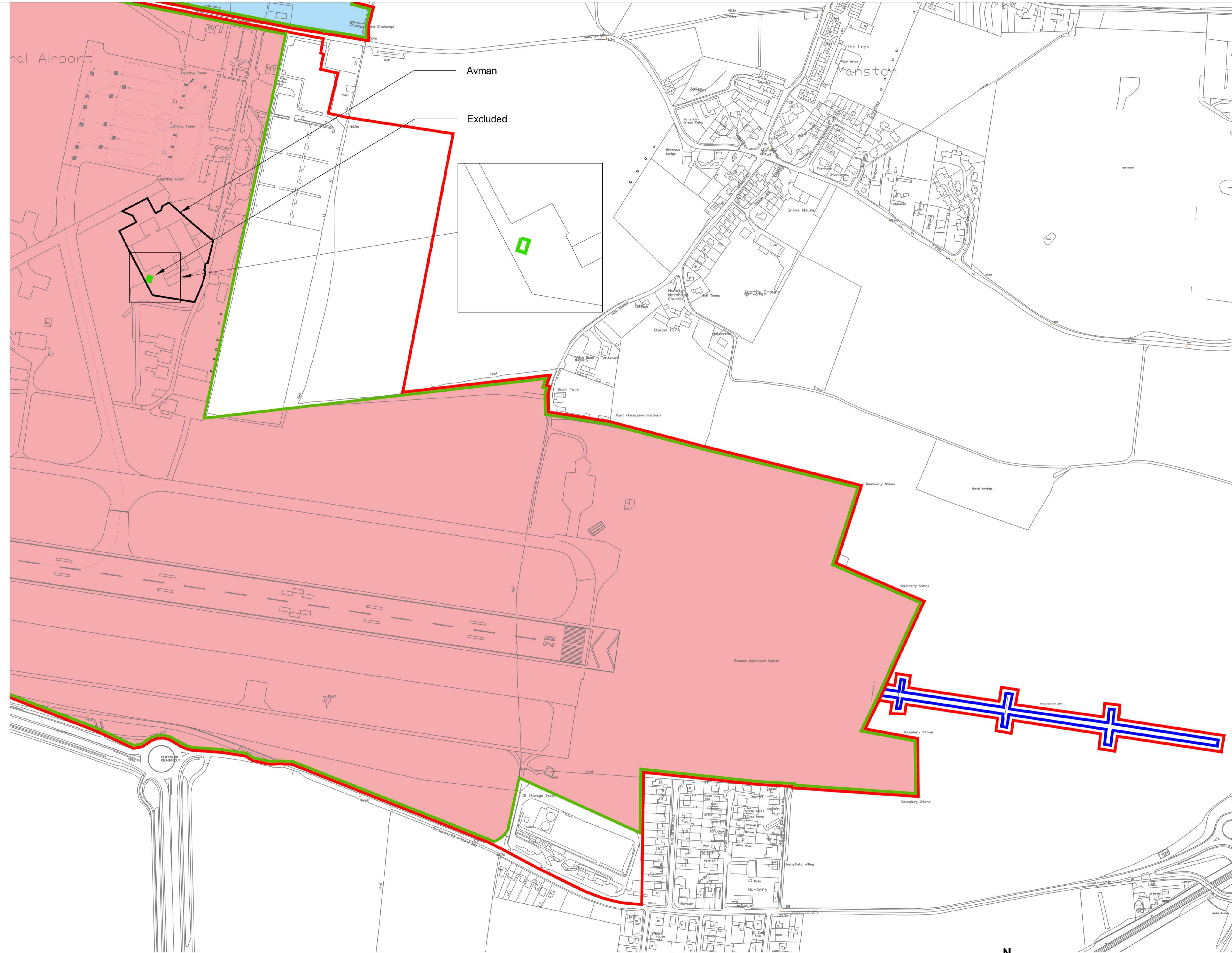

© 2016 RPS Group

Notes

1. This drawing has been prepared in accordance with the scope of RPS's appointment with its client and is subject to the terms and conditions of that appointment. RPS accepts no liability for any use of this document other than by its client and only for the purposes for which it was prepared and provided.
2. If received electronically it is the recipient's responsibility to print to correct scale. Only written dimensions should be used.
3. This drawing should be read in conjunction with all other relevant drawings and specifications.

Key Plan
Scale @ 1:50000



KEY

- Proposed Development
- Land to which access is sought
- Land owned by RiverOak
- Leasehold Land (Excluded)
- K803975 (Plot 1)
- K837264 (Plot 2)
- K806190 (Plot 3)
- K891199 (Plot 4)
- Powermain, Polar, Polar Heli, Taft Intl Plots and Avman

P03	Note to Avman changed.	JH	CJ	21.11.16
P02	Hatches and red line boundary adjusted. Key updated.	JH	CJ	18.11.16
P01	First Issue.	DDP	CJ	11.11.16
Rev	Description	By	Ckd	Date

RPS

Sherwood House, Sherwood Avenue,
Newark, Nottinghamshire, NG24 1QQ
T: 01636 605 700 E: rpsnewark@rpsgroup.com

Client **RIVER OAK INVESTMENT CORP., LLC**

Project Manston Airport Masterplan

Title Section 53 Access Plan - Sheet 5 of 5

Status	Scale	Date Created
Preliminary	1:2500 @A1	11.11.16
Project Leader	Drawn By	Checked by
GDD	DDP	CJ

Document Number	Revision	Suitability
NK018417-RPS-MSE-X-DR-C-0124	P03	S0
Project Number	Signature / Date / Issue / Type / Risk / Drawing Number	